

Accu-Chek Insight Training Chart

New handling instructions for changing a cartridge

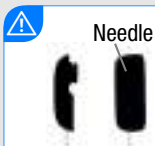

- Always disconnect the infusion set from your body before changing the cartridge.
- Always use a new adapter when changing the cartridge.
- A needle is located in the centre of the adapter nose. Insulin delivery is only guaranteed if the needle is fitted onto the cartridge centrally in a perpendicular manner (see step 11).

- If an empty cartridge is inserted into the pump (e.g. for training purposes), the pump displays the programmed insulin deliveries (infusion set priming, basal rate and bolus deliveries), even though no insulin is being delivered due to the empty cartridge.
- Selecting the wrong cartridge type can lead to underdelivery or overdelivery of insulin.

Step 1: How to remove an empty cartridge

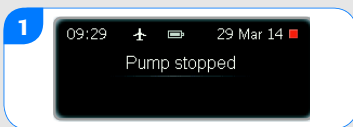

From the Status screen, press .

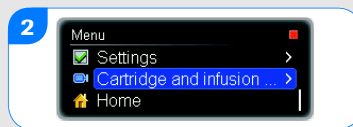

The main Menu appears.
Press to move to Cartridge and infusion set.
Press to select.

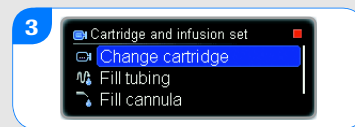

The Cartridge and infusion set menu appears.
Press to select Change cartridge.



The Change cartridge screen appears.



Hold the pump in an upright position.
Turn the adapter with the tubing anti-clockwise.

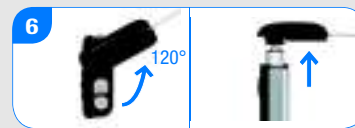

When you reach an angle of about 120°, remove the adapter with the cartridge.

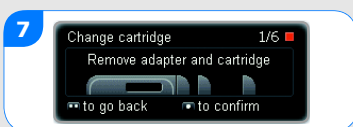

Important: Press to confirm that you have removed the adapter and the cartridge. The pump automatically starts rewinding the piston rod.

You may damage your pump or cartridge if the piston rod is not rewound.

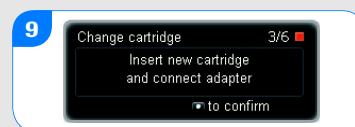
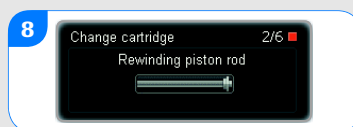

When the pump finishes rewinding, you are prompted to insert the new cartridge and connect the adapter.

Only insert a new cartridge if the Insert new cartridge and connect adapter screen appears.

Note

- Always check the cartridge, including the rubber plunger at the bottom of the cartridge. Do not use it if any damage or leakage is seen or if the rubber plunger has been drawn above the white label band at the bottom of the cartridge. This could be a result of leakage of insulin. If you suspect the cartridge is damaged, take it back to your supplier.
- Do not use the insulin cartridge if the cartridge or the insulin pump containing the cartridge is dropped, damaged or crushed.

Step 2: How to insert a new cartridge

Ensure the cartridge and insulin are at room temperature.



Make sure you hold the pump in an upright position.
Insert the cartridge – plunger first – into the cartridge compartment.

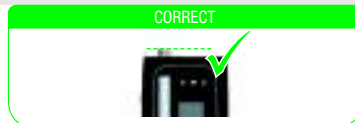

Make sure that the cartridge fits correctly. If the cartridge does not fit as shown, **check steps 1 to 7**.



Do **not** push the cartridge into the pump if the cartridge is sticking out. This may damage the pump or the cartridge.
Make sure that the piston rod has rewound completely. If the piston rod has not rewound completely, **contact your local pump support**.



Place a new adapter on the bayonet socket of the cartridge compartment. Make sure you insert the nose of the adapter into the notches of the pump's housing at a right angle (90°). Otherwise the needle could bend.



Place the adapter on the bayonet socket of the cartridge compartment **only** as described in **step 11**.



Do **not** place the adapter on the bayonet socket of the cartridge compartment if the adapter is not positioned as described in **step 11**.



Turn the adapter clockwise all the way until it stops. The adapter is correctly positioned when it is aligned with the pump's housing.
Then press **OK** to confirm.

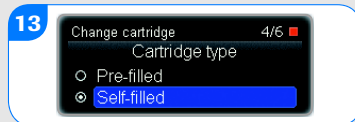

The **Cartridge type** screen appears.
Press **▲** or **▼** to move to the appropriate cartridge type.
Press **OK** to select.

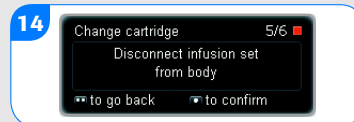

You are prompted to disconnect the infusion set from your body.
Press **OK** to confirm.

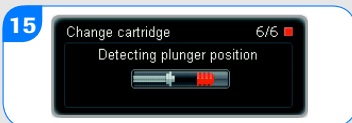

The pump detects the position of the plunger in the cartridge.

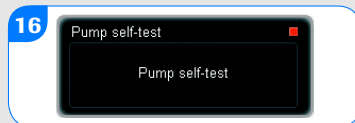

The pump then performs a self-test.

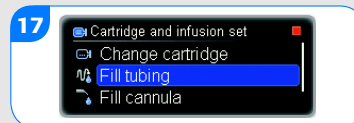

After the self-test, the pump returns to the **Cartridge and infusion set** menu. **Fill tubing** is selected by default.

ACCU-CHEK and ACCU-CHEK INSIGHT are trademarks of Roche.

© 2016 Roche Diabetes Care

Roche Diabetes Care GmbH
Sandhofer Strasse 116
68305 Mannheim, Germany
www.accu-check.com



ACCU-CHEK®